

PLOT 7E OUTLINE ONLY: REFER TO PARAMETER PLANS & DESIGN GUIDE

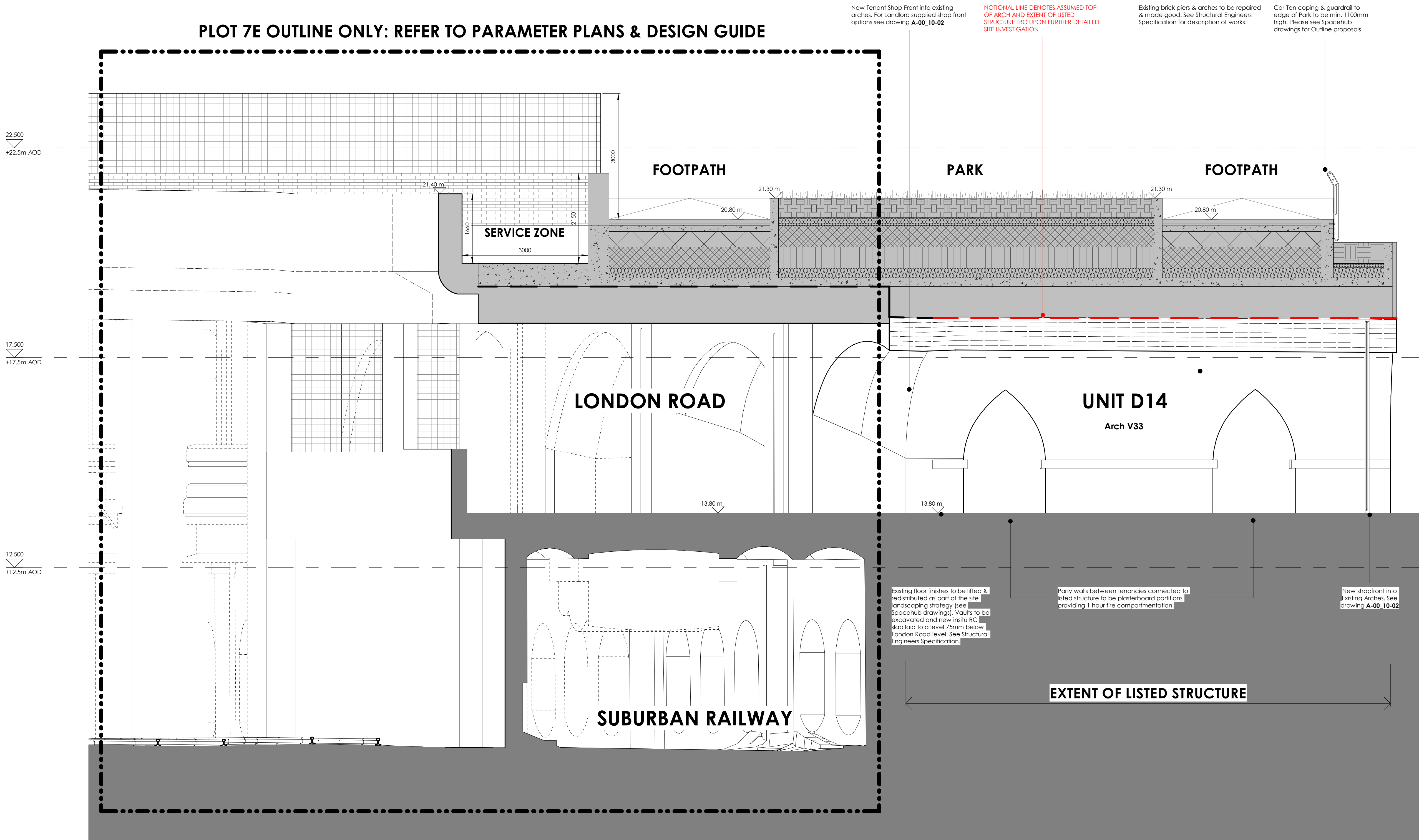

JACK ARCHED LID TO LONDON ROAD - This significantly contributes to the character of London Road and is generally to be retained and repaired with cut outs over the new Public Squares.

KEY

- AREA OUTSIDE SCOPE OF APPLICATION
- REFER TO STRUCTURAL, M&E & LANDSCAPE CONSULTANT PROPOSALS FOR DETAILS
- PROPOSED GOODSYARD PLOTS OUTSIDE SCOPE OF PLOT 7 LBA

NOTE: REFER TO SPACE HUB DRAWINGS FOR SITE-WIDE LEVELS, PUBLIC REALM & LANDSCAPING

REFER TO WSP DRAWINGS FOR SITE-WIDE ATTENUATION & DETAILS OF PODIUM LEVEL FOUNDATIONS

REFER TO PLOWMAN CRAVEN SURVEY DRAWINGS:
1.5532-010T-01 (A) - 3D Street Survey
1.5532-010T-03 (A) - Boundary Drawing
1.5532-010B-01 (A) - Viaduct Structure Plan
1.5532-010W-02 (A) - Railway Cutting
1.5532-013E-02 (A) - Brick Lane Elevations
1.5532-013T-01 (B) - Planimetric Survey
W1.5532-010SM - 3D Arch Survey

FOR DETAIL OF ARCHES REFER TO:
KMH HERITAGE STATEMENT & ALAN BAXTER CONDITION SURVEY

1 Plot 7D13 - Proposed Section
1 : 50



Do not scale this drawing
Do not derive dimensions from digital media

Rev	Date	Drawn By	Checked By	Rev	Date	Revision Notes	Drawn By	Checked By	Rev	Date	Revision Notes	Drawn By	Checked By	Drawing Status:	Suitability:	Drawing No:	Rev:
														PLANNING FOR APPROVAL	-	BGY-FBA-00-XX-DR-A-00_10-7D13	P1
														Job Title:	Job No:	© Drawing & Design Copyright of:	
														The Goodyard	3465		
														Drawing Title:	Plot 7D - Proposed Section Sheet 3		FAULKNERBROWNS ARCHITECTS
														Date:	Scale:	Drawn By:	Checked By:
														April 19	As indicated	SO	PG



Faulkner Browns LLP
Osborn House
Northumbrian Way
Killingworth
Newcastle upon Tyne
NE12 6DW
T+44(0)191 2683007
F+44(0)191 2478132